

Building site	Area-elastic wooden floor
constructor	Date

9.12.2005 Ska

Scale 1:5

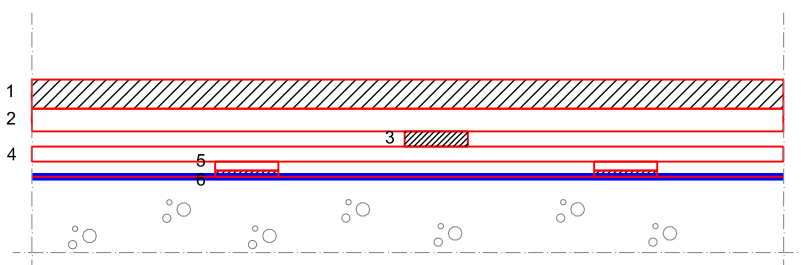

KARELIA SPRING

1	Karelia self-supporting parquet - natur selection Karelia Spring tripleflex underframe body, C-C	21,0 mm or 23 mm 350, 45° or 300 mm 45°
2	- 18 x 50, Elastic support of special birch plywood	18,0 mm
3	- 50 x 50, plywood	12,0 mm
4	- 12 x 50, Elastic support of special birch plywood	12,0 mm
5	- 50 x 50, plywood	6,5 mm
6	- Elastic rubber shock pad	5,0 mm

- structural height 75,0 mm or 77 mm

- DIN 18032 approved area-elastic wooden floor

Basic subfloor requirements:

Concrete slab: levelled and vacuumed. Subfloor is buyer's responsibility.

Subfloor levelness tolerance: 3 mm in radius of 2000 mm

Maximum subfloor moisture content 85 %

Relative air humidity range 40-60 %

Areas of use: multi-purpose